

R I V E R T H E G A N G A

22°40'30.14"N
88°21'12.43"E

22°40'26.25"N
88°21'11.04"E

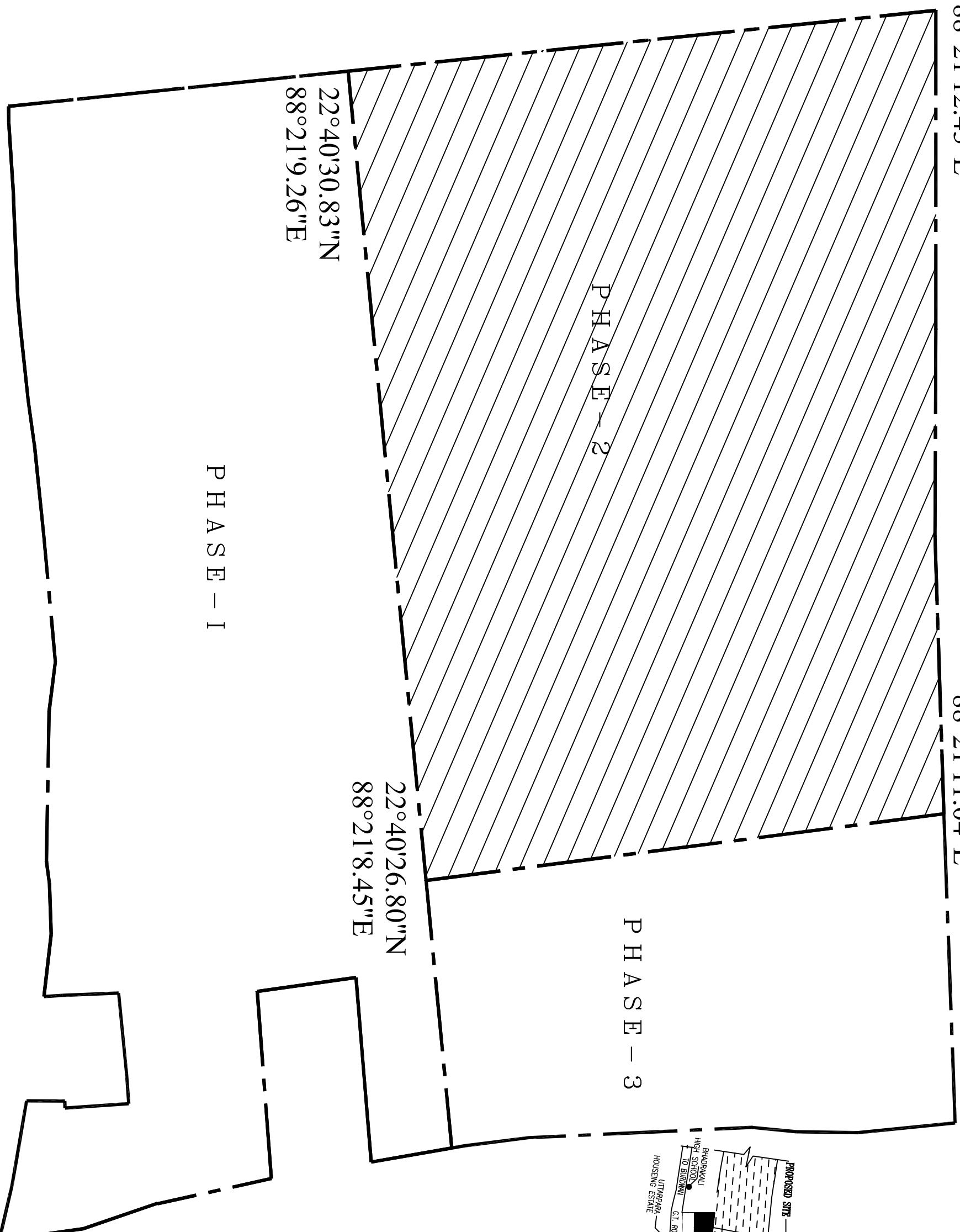

22°40'30.83"N
88°21'9.26"E

P H A S E - 2

P H A S E - 3

22°40'26.80"N
88°21'8.45"E

P H A S E - 1

G . T . R O A D

PROPOSED G+XI (36.0 MT. HT.), STORIED RESIDENTIAL & G+V (18.0 MT. HT.) STORIED
COMMERCIAL BUILDING AT HOLDING NO.-20 & 22, B. G.T. ROAD, BHADRAKALI, HOOGHLY.

